

# Cultural and Educational Quarter

# Cultural and Educational Quarter Development Area

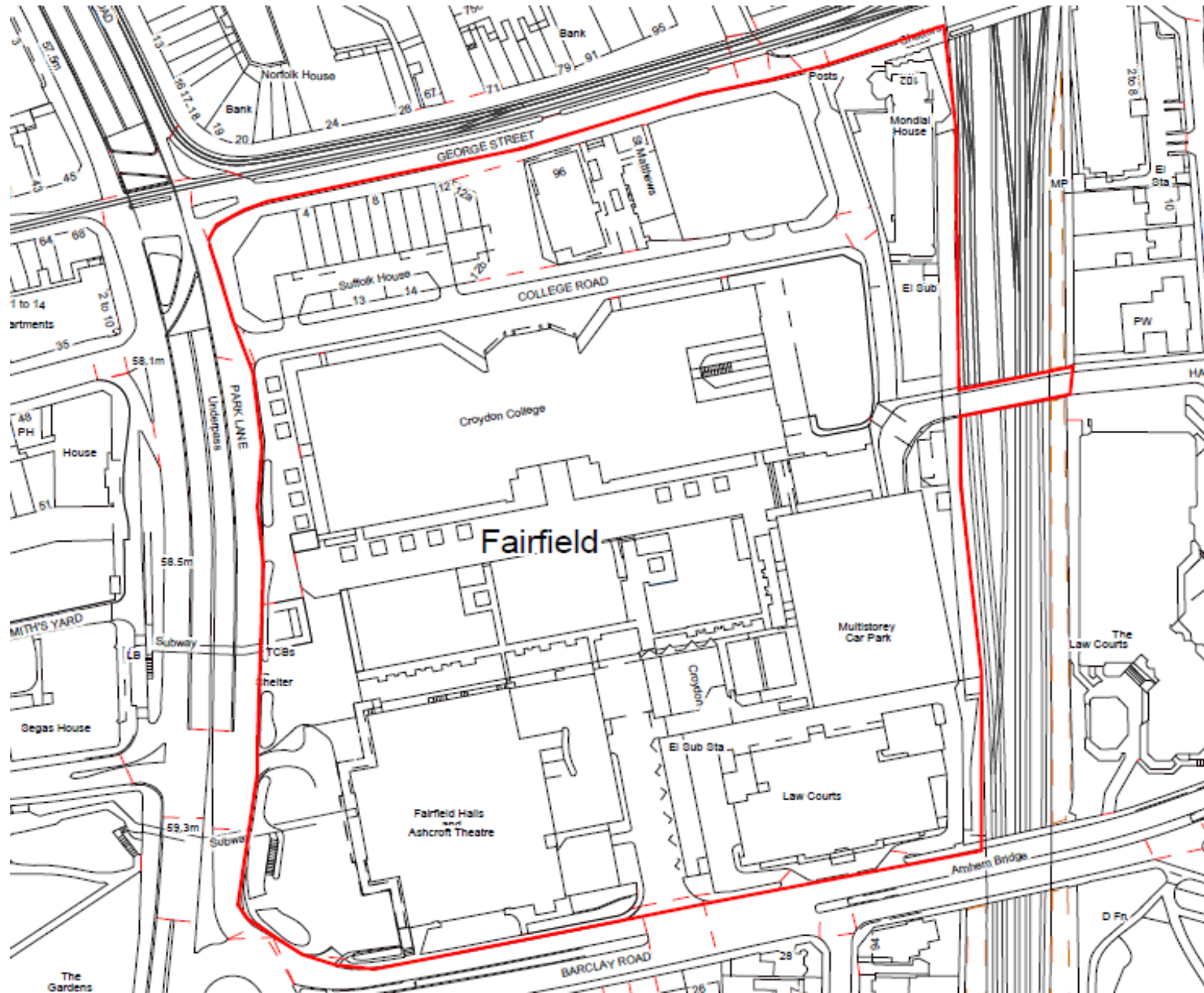

# Cultural and Educational Quarter Development

- 1) A vibrant mix of uses including new homes, cultural space, educational space, shops and restaurants
- 2) A modern, flexible Fairfield Halls including new public facing food and beverage spaces
- 3) A new purpose built Croydon College building suitable for high quality education provision
- 4) A high quality new public space suitable for both rest and play
- 5) A new step free through route to and from East Croydon station and the rest of the town centre.





FAIRFIELD HALL

THE UNIVERSITY LIBRARY



# PHASE 1

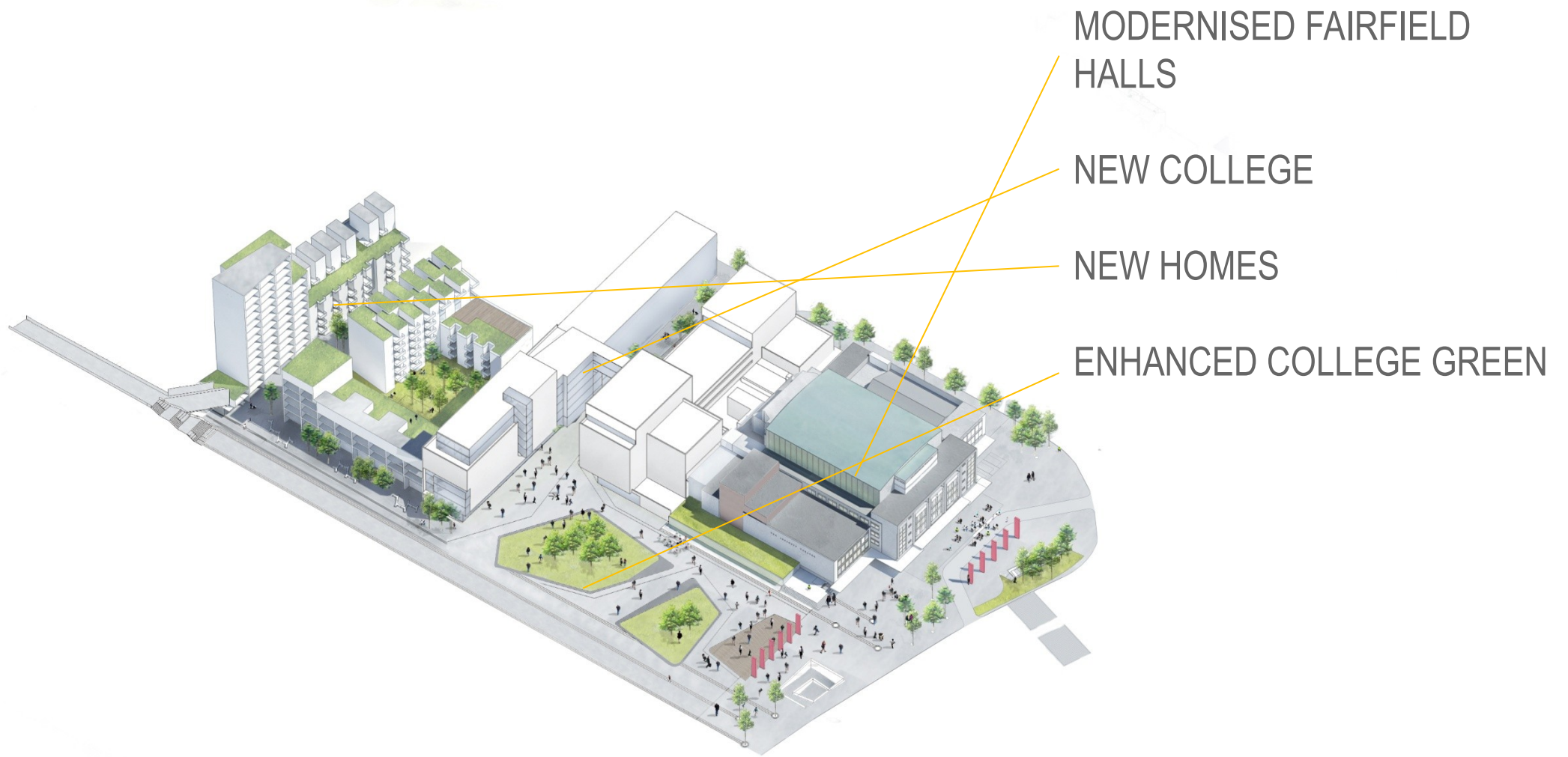



# FULL SCHEME

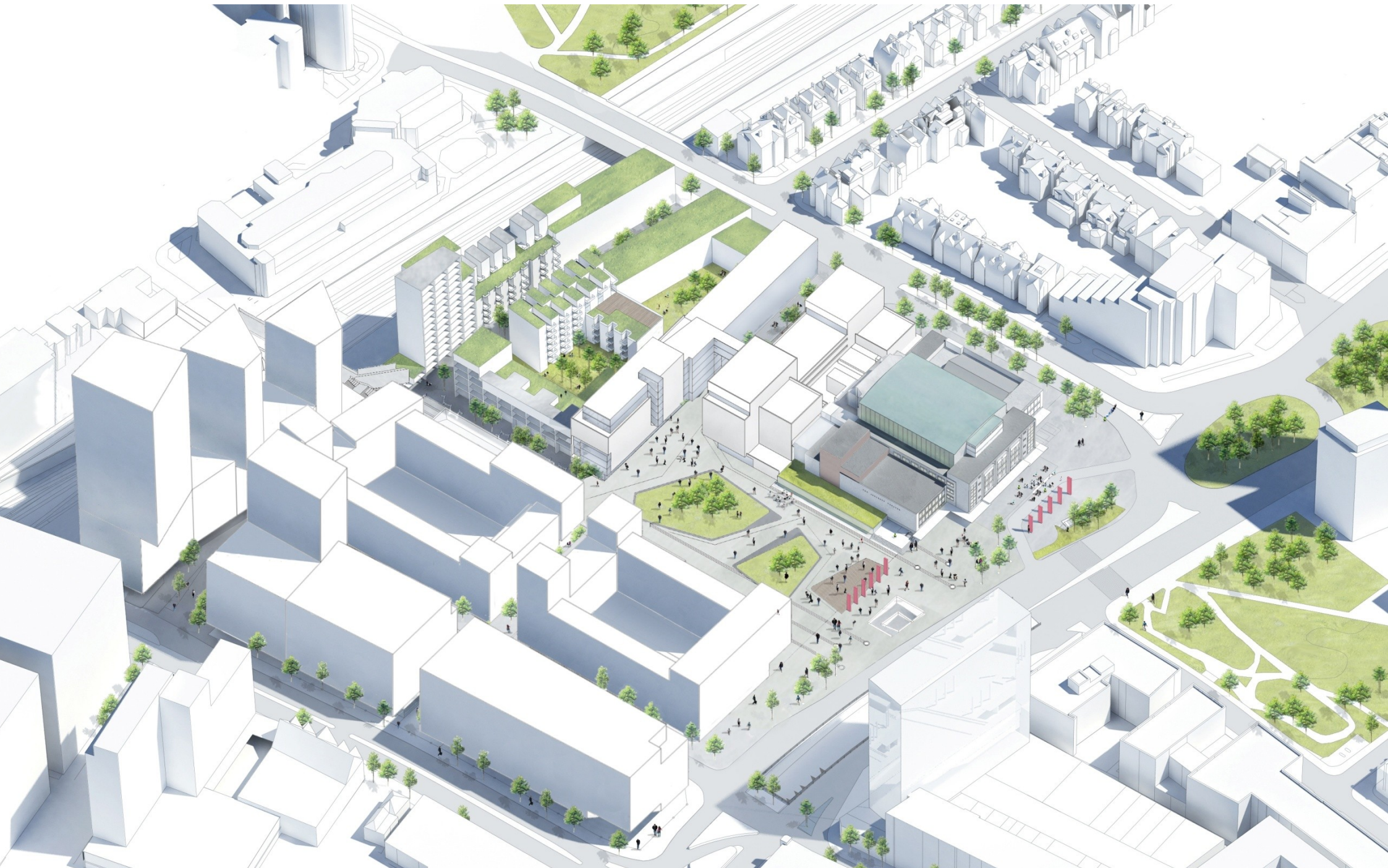

ARCHITECTURAL LIGHTING AND SIGNAGE SYMPATHETIC TO ENHANCING QUALITY HERITAGE ARCHITECTURE.

NEW BOX OFFICE 'WELCOME', VISUAL AND PHYSICAL CLUTTER TO FOYERS REMOVED

CLEAR & IMPROVED CIRCULATION.

FLEXIBLE SPACES

REPLACE NEW SEATS

INCREASED STAGE SIZE

MOTORISED CHOIR SEATING

BACK OF HOUSE

DIRECT GET-IN ACCESS

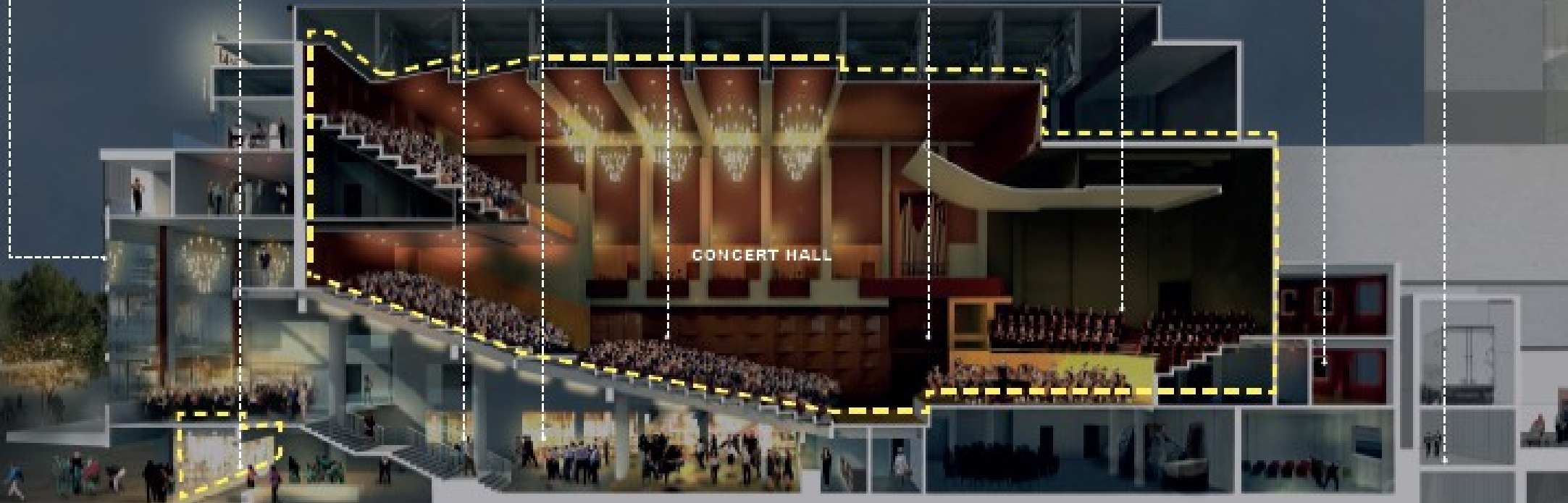





CROYDON COLLEGE

THE ASHCROFT THEATRE

Performance

FORTHKINGTONSVERKE  
www.forthkingtonsverke.no



## Indicative Programme

- Design phase for the project – April to September 2015
- Second planning committee presentation – 22 October 2015
- Planning application submitted including detailed planning for phase 1 schemes – Dec 2015
- Planning decision – April 2016
- Phase 1 schemes start on site – Summer 2016
  - Modernisation of Fairfield Halls
  - Development on multi-story car park
  - New college facility at Barclay Road
- Forecast completion of Phase 1 schemes – 2018